



Sheraton[®]

KANSAS CITY HOTEL
AT CROWN CENTER



Floor Plans and Capacity Charts



Sheraton®

KANSAS CITY HOTEL
AT CROWN CENTER

Meeting Space Overview

SHERATON KANSAS CITY HOTEL AT CROWN CENTER BY THE NUMBERS

Total Guestrooms: 730 guestrooms and suites

Total Meeting Rooms: 25

Maximum Group Size: 3,900

Total Meeting Space: 88,360 sq. ft. / 8,209 sq. mt.

Additional spaces for meetings and events, not displayed here, may also be available. Contact your hotel representative for more information.

BALLROOM LEVEL

- 1 Boardroom
- 2 The Grand Office
- 3 Atlanta
- 4 New York
- 5 San Francisco
- 6 Chicago

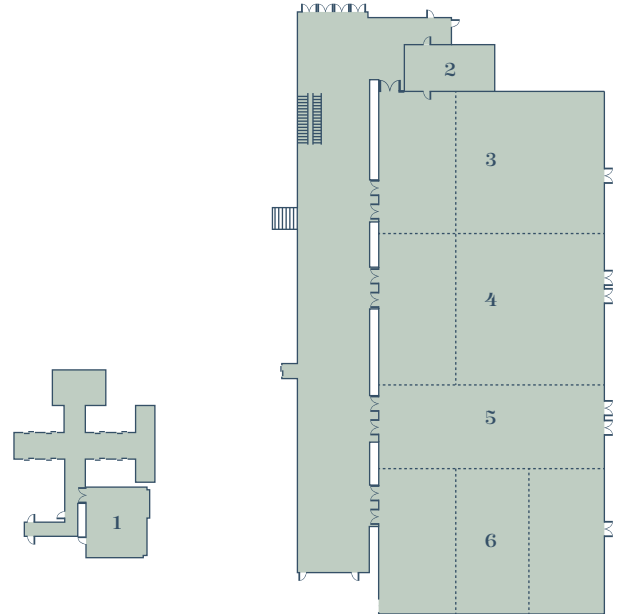
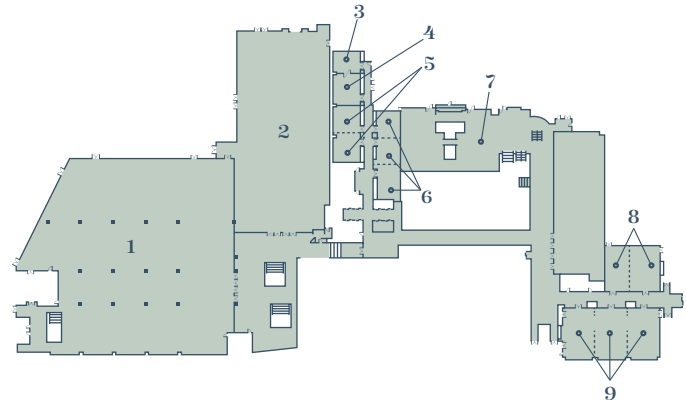

EXHIBIT HALL AND MEZZANINE LEVEL

- 1 Exhibit Hall A
- 2 Exhibit Hall B
- 3 Northrup
- 4 Fremont
- 5 Benton
- 6 Van Horn
- 7 The Terrace
- 8 Chouteau
- 9 Empire



LOBBY LEVEL

- 1 Gillham Hall

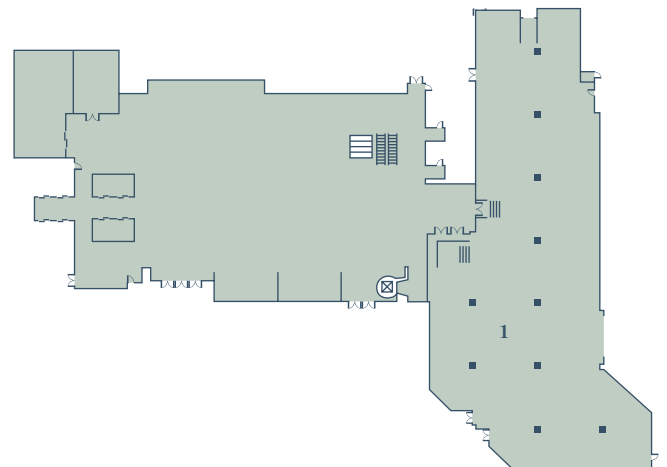

This document contains approximate measurements and square footage that are for illustrative purposes only. We cannot guarantee the floor plan accuracy or completeness, therefore encourage you to review the space to make sure it is suitable for your event.



Sheraton[®]

KANSAS CITY HOTEL
AT CROWN CENTER

Meeting Space: Ballroom Level

BALLROOM LEVEL

- 1 Boardroom
- 2 The Grand Office
- 3 Atlanta
- 4 New York
- 5 San Francisco
- 6 Chicago
- 7 The Grand Ballroom

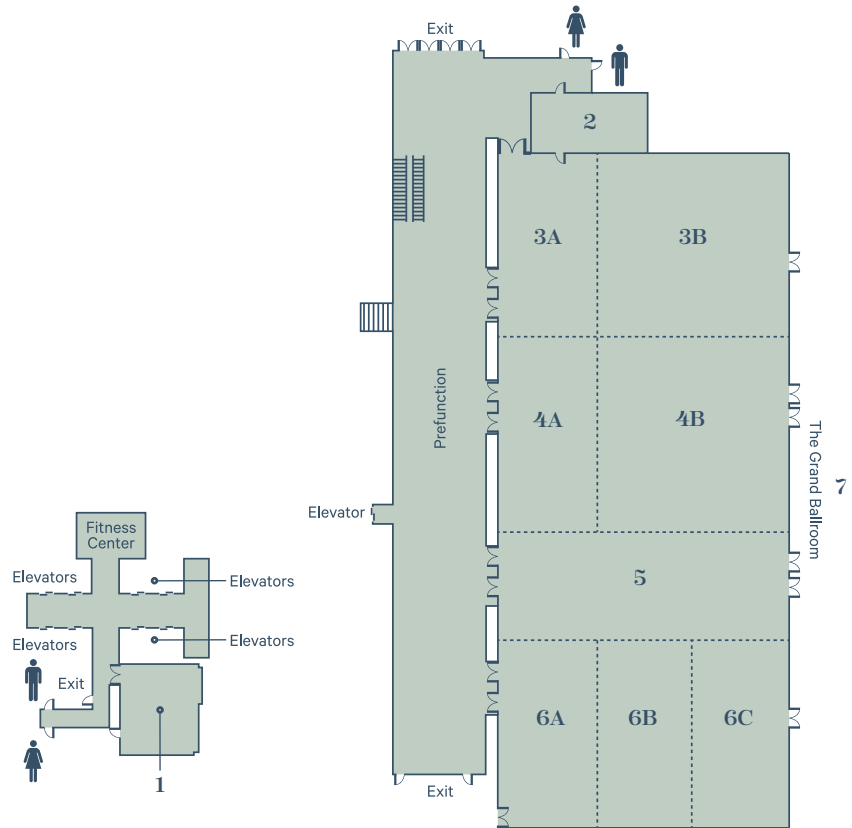

	SQUARE FEET	DIMENSIONS	HEIGHT	THEATER	CONFERENCE	RECEPTION	CLASSROOM	U-SHAPE	SQUARE	ROUND
BOARDROOM	607	22.5' x 27'	9.5'	-	20	-	-	-	-	-
THE GRAND OFFICE	240	20' x 15'	-	-	-	-	-	-	-	-
ATLANTA*	4,754	54.98' x 86.47'	17.98'	546	48	370	288	84	72	280
NEW YORK*	5,010	86.47' x 57.94'	17.98'	651	48	527	336	87	96	280
SAN FRANCISCO*	2,809	86.47' x 32.49'	17.98'	357	72	295	144	75	84	140
CHICAGO*	4,796	86.47' x 55.47'	17.98'	630	72	504	336	84	96	280
THE GRAND BALLROOM*	17,370	86.47' x 200.88'	17.98'	2,332	-	1,828	1,353	-	-	1,320

*ADDITIONAL ROOMS AVAILABLE IN THIS SPACE, CALL FOR MORE INFORMATION.

SHERATON KANSAS CITY HOTEL AT CROWN CENTER
2345 McGee Street
Kansas City, Missouri 64108
T 816 841 1000 F 816 398 4610
sheratonkansascityhotel.com



Sheraton[®]

KANSAS CITY HOTEL
AT CROWN CENTER

Meeting Space: Exhibit Hall and Mezzanine Level

EXHIBIT HALL AND MEZZANINE LEVEL

- 1 Exhibit Hall A
- 2 Exhibit Hall B
- 3 Northrup
- 4 Fremont
- 5 Benton
- 6 Van Horn
- 7 The Terrace
- 8 Chouteau
- 9 Empire

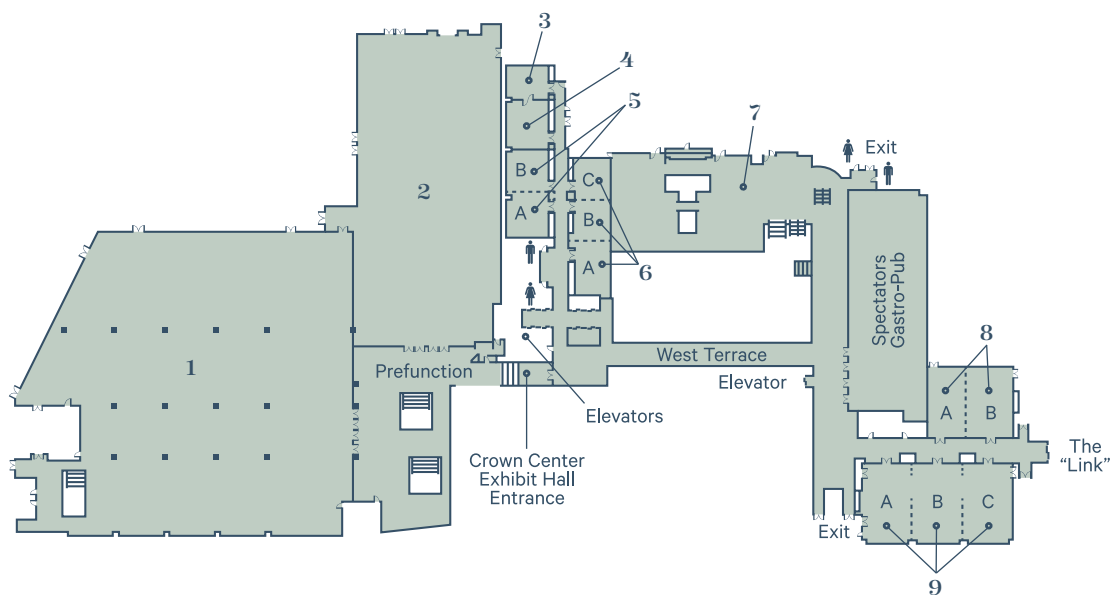

	SQUARE FEET	DIMENSIONS	HEIGHT	THEATER	CONFERENCE	RECEPTION	CLASSROOM	U-SHAPE	SQUARE	ROUND
EXHIBIT HALL A	27,915	200.2' x 178.9'	19.5'	2,550	-	2,938	-	-	-	2,010
EXHIBIT HALL B	15,556	102.4' x 189.3'	19.5'	1,800	-	1,637	1,050	-	-	1,050
NORTHRUP	440	27.4' x 19.2'	9.9'	35	12	46	18	15	12	20
FREMONT	674	27.5' x 28'	9.9'	65	18	70	30	18	18	30
BENTON*	1,216	27.5' x 51'	9.9'	99	36	60	48	33	36	80
VAN HORN*	1,669	24.4' x 81.6'	9.9'	180	66	175	90	69	66	60
THE TERRACE	5,606	59.7' x 118.2'	36.6'	360	-	590	-	-	-	220
CHOUTEAU*	2,078	41.2' x 53.1'	9.9'	261	36	218	147	42	54	120
EMPIRE*	3,936	44.9' x 91.4'	9.5'	462	72	414	252	78	90	210

*ADDITIONAL ROOMS AVAILABLE IN THIS SPACE, CALL FOR MORE INFORMATION.

SHERATON KANSAS CITY HOTEL AT CROWN CENTER

2345 McGee Street
Kansas City, Missouri 64108
T 816 841 1000 F 816 398 4610
sheratonkansascityhotel.com



Sheraton[®]

KANSAS CITY HOTEL
AT CROWN CENTER

Meeting Space: Lobby Level

LOBBY LEVEL

1 Gillham Hall

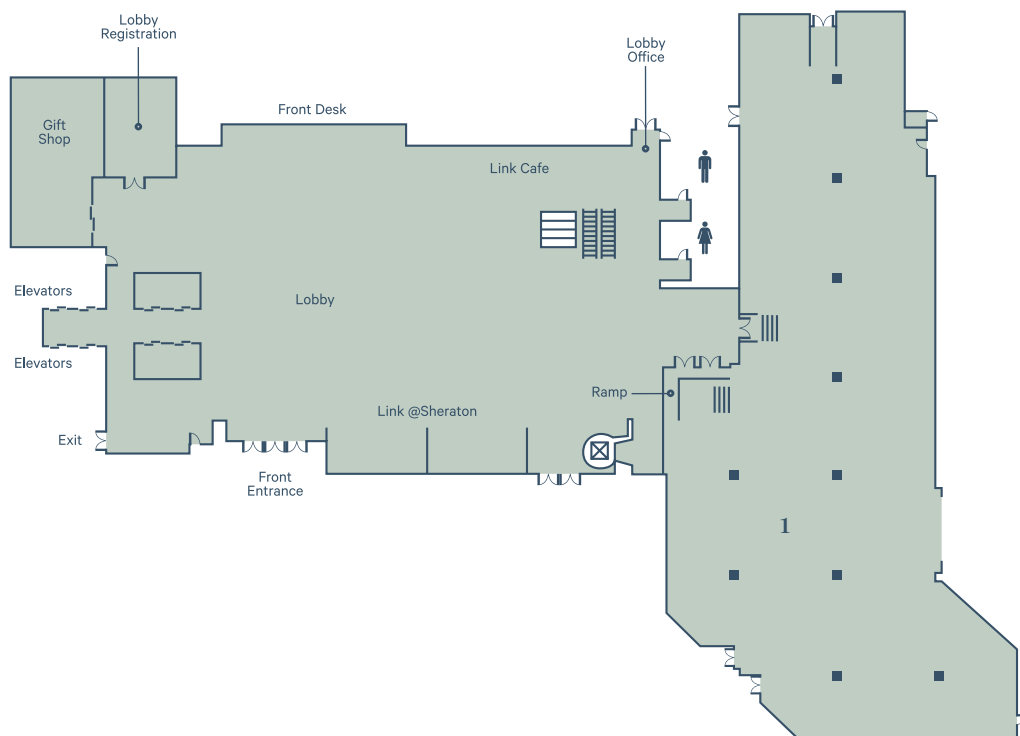

	SQUARE FEET	DIMENSIONS	HEIGHT	THEATER	CONFERENCE	RECEPTION	CLASSROOM	U-SHAPE	SQUARE	ROUND
GILLHAM HALL	14,044	103.6' x 211.81'	11.62'	1,200	-	1,478	573	-	-	710

SHERATON KANSAS CITY HOTEL AT CROWN CENTER
2345 McGee Street
Kansas City, Missouri 64108
T 816 841 1000 F 816 398 4610
sheratonkansascityhotel.com



Sheraton®

KANSAS CITY HOTEL
AT CROWN CENTER



SHERATON KANSAS CITY HOTEL AT CROWN CENTER

2345 McGee Street
Kansas City, Missouri 64108
T 816 841 1000 F 816 398 4610
sheratonkansascityhotel.com